

DIN - 675

REMACHES PARA CORREAS

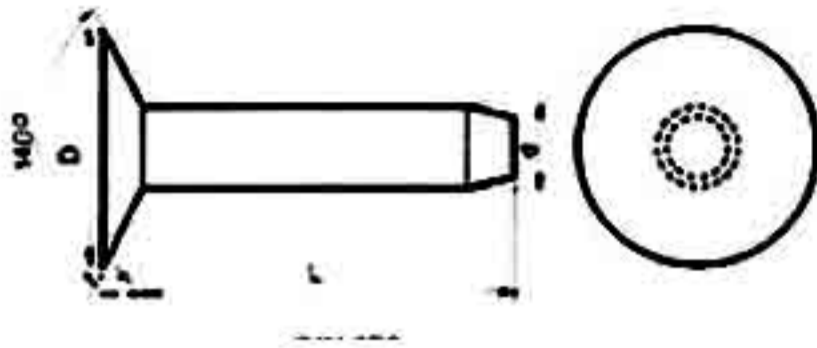

d	3	4	5
D	8,3	11	13,8
k	1	1,3	1,6
L mm*	Weights in kg per 1000 pieces		
6	0,53		
8	0,66		
10	0,79	1,44	2,42
12	0,91	1,67	2,77
16	1,16	2,11	3,46
20	1,42	2,56	4,16
25		3,12	5,03
30			5,90