

DIN - 467

TUERCA MOLETEADA FORMA BAJA

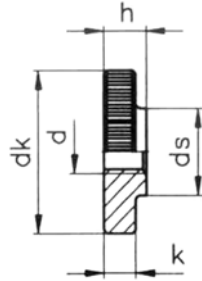

	dk	d_s max.	h max.	K max.
M-2	9	4,5	2,5	2
M-2,5	11	5	3	2,5
M-3	12	6	3	2,5
M-4	16	8	4	3,5
M-5	20	10	5	4
M-6	24	12	6	5
M-8	30	16	8	6
M-10	36	20	10	8