

# DIN - 466

## TUERCA MOLETEADA FORMA ALTA

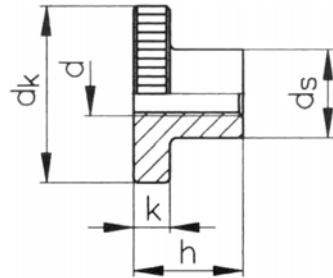

	$d_k$	$d_s$ max.	$h$ max.	$K$ max.
<b>M-2</b>	9	4,5	5,3	2
<b>M-2,5</b>	11	5	6,5	2,5
<b>M-3</b>	12	6	7,5	2,5
<b>M-4</b>	16	8	9,5	3,5
<b>M-5</b>	20	10	11,5	4
<b>M-6</b>	24	12	15	5
<b>M-8</b>	30	16	18	6
<b>M-10</b>	36	20	23	8