

DIN - 431

TUERCA ROSCA GAS PARA TUBOS

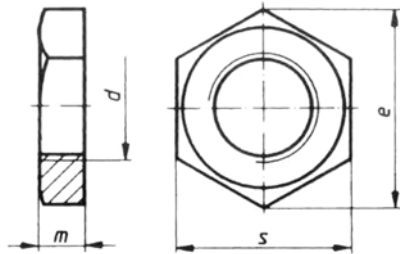

	Nº hilos x pulgada	m	s	e
G 1/8	28	6	19	20,88
G 1/4	19	6	22	23,91
G 3/8	19	7	27	29,56
G 1/2	14	8	32	35,03
G 5/8	14	8	32	35,03
G 3/4	14	9	36	39,55
G 7/8	14	9	41	45,2
G 1	11	10	46	50,85
G 1 1/4	11	11	55	60,79
G 1 1/2	11	12	60	66,44
G 2	11	13	75	82,6